

## type of nozzle: axial - hollow cone - nozzles H

nozzles with spin employment

### characteristics of nozzle

Hollow cone spray pattern with circular surface wetting by spin employment.

### application

air and gas scrubber  
dust suppression  
cooling  
cleaning  
atomizer drying process  
superheated steam cooling

### material

brass  
steel  
high-grade steel  
plastic  
other one on request

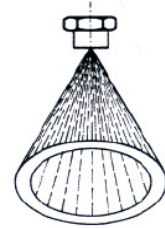

**hollow cone spray pattern**

**Pic. 1**

dimensions in mm				
R + G	L 45°-90°	L 120°	L1	SW
1/8"	15	18	7	13
1/4"	18	18	10	14
3/8"	19	19	10	17
1/2"	25	25	13	22
3/4"	26	34*	15	27
1"	30	40*	17	36

thread R = DIN 2999  
\* is thread G ISO 228

plastic nozzles can exhibit other SW

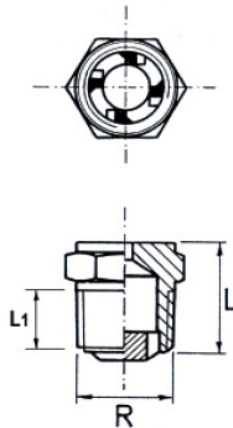

**Pic. 2**

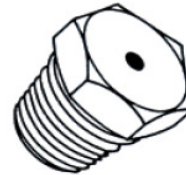

**spray angle  
45° - 60° - 90°**

**Pic. 3**

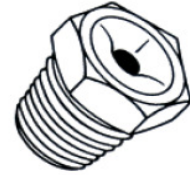

**wide spray angle  
120°**

**order example: (threads - type - spray angle - material) 3/8" - H 7 - 60° - steel**

B = orifice diameter, E = closest cross section, the drilling vary with different spray angles easily

The following spray angles are available: 45°-60°-90°-120°, other spray angles on request

male thread R DIN 2999						Type	drilling (mm)		flow rate V (l/min.) with pressure p (bar)													
1/8"	1/4"	3/8"	1/2"	3/4"	1"		B	E	bar 0,3	bar 0,5	bar 1	bar 1,5	bar 2	bar 3	bar 4	bar 5	bar 6	bar 7	bar 10	bar 20		
*	*					H 1	1,2	0,5			0,35	0,41	0,47	0,56	0,64	0,72	0,79	0,85	1,00	1,90		
*	*					H 2	1,3	1,5			0,46	0,53	0,61	0,80	0,89	1,10	1,30	1,50	1,90	2,80		
*	*					H 3	1,3	0,7			0,70	0,86	1,00	1,20	1,40	1,65	1,80	2,00	2,30	3,30		
*	*					H 4	1,8	1,0			1,00	1,30	1,65	2,00	2,60	3,20	3,70	4,20	4,60	5,80	8,10	
*	*					H 5	2,0	1,0			1,50	1,90	2,30	2,60	3,20	3,80	4,30	4,70	5,20	6,30	9,20	
	*					H 6	2,5	1,0			1,90	2,30	2,70	3,20	3,90	4,60	5,20	5,70	6,20	8,50	12,6	
	*	*				H 7	3,2	1,2			2,30	3,20	3,90	4,60	5,60	6,40	7,20	7,90	8,50	12,2	14,3	
	*	*				H 8	3,8	1,5			2,60	3,80	4,60	5,40	6,60	7,70	8,60	9,40	10,2	12,3	17,5	
		*	*			H 9	3,5	1,2			3,20	4,50	5,50	6,50	7,60	8,80	10,0	11,0	12,0	14,5	21,0	
		*	*			H 10	4,0	1,2			4,00	5,30	6,40	8,00	10,0	11,2	12,5	14,0	15,5	18,0	24,0	
		*	*			H 11	4,6	1,5			4,50	6,20	7,50	8,50	10,2	11,8	13,1	14,5	16,5	19,0	26,0	
		*	*			H 12	4,8	2,0			4,00	5,50	7,60	9,50	11,5	13,0	15,3	17,0	19,0	20,5	25,0	35,0
		*	*			H 13	5,0	2,0			4,50	6,30	9,00	10,7	12,5	15,0	17,5	19,5	22,0	24,0	28,0	40,0
			*	*		H 14	5,5	2,5			5,50	7,80	11,0	13,5	16,0	19,0	22,5	25,0	27,0	30,5	36,0	50,0
			*	*		H 15	6,0	2,5			6,50	8,70	12,0	14,5	17,5	20,0	23,5	26,0	28,0	30,5	38,0	54,0
				*		H 16	6,4	2,5			7,50	10,0	14,0	17,5	20,0	24,5	28,0	31,0	35,0	38,0	45,0	62,0
				*	*	H 17	6,6	3,0			9,00	12,5	18,0	21,5	25,0	30,5	36,0	40,0	45,0	48,0	56,0	78,0
				*	*	H 18	7,0	3,0			11,7	15,0	21,3	22,5	30,0	36,6	42,3	47,4	51,6	56,1	66,9	94,8
				*	*	H 19	7,5	3,5			15,6	20,0	28,4	30,0	40,0	48,8	56,4	63,2	68,8	74,8	89,2	126
				*	*	H 20	7,8	4,0			19,5	25,0	35,5	37,5	50,0	61,0	70,5	79,0	86,0	93,5	112	158